

Parts List:

Part No:	Description:	Size:	Torque	Qty:
1	Crossbar			1
2	R/H Sidearm			1
3	R/H Sidearm Long			1
4	L/H Sidearm			1
5	L/H Sidearm Long			1
6	Bolt + Washer (30mm OD) + Lock Washer	M12 x 45 x 1.75	80Nm	8
7	2 x Bolt + 4 Washers (30mm OD) + 2 x Nyloc Nuts	M12 x 45 x 1.75	80Nm	2
8	Bolt + Washer (30mm OD) + Lock Washer	M12 x 45 x 1.75	80Nm	2
9	Coupling Packer	10mm		1
10	4 x Bolt + 8 x Washer (30mm OD) + 4 x Nyloc Nuts	M12 x 45 x 1.75	80Nm	4
11	Electrics Plate			1
12	Towball Cover			1
13	Bolt + Lock Washer + Nut	M16 x 60 x 2.0	200Nm	2

Fitting:

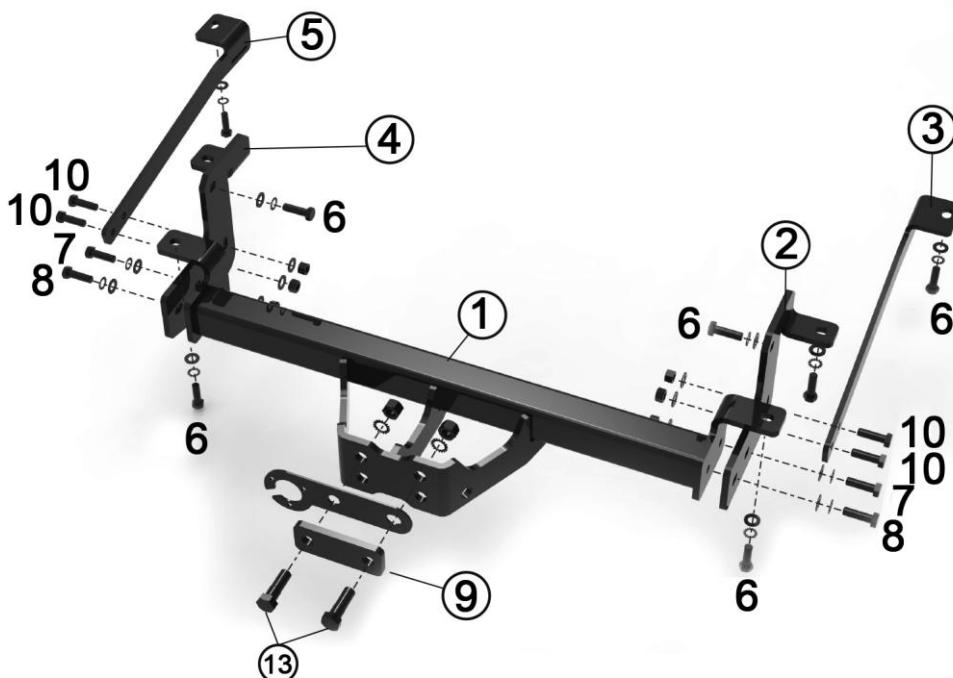

Fitting:

1. Remove the towing eye located on the left hand chassis rail and clean captive threads thoroughly.
2. Using bolts (6), attach but do not secure, crossbar (1) to the rear most mounting points to support the weight.
3. Attach, but do not secure, sidearm (2) to the chassis using bolts (6). Fit bolts (7) & (8) to the cross bar.
4. Attach, but do not secure, sidearm (3) to the vehicle using bolts (6). Secure sidearm (2) to sidearm (3) using bolts (10).
5. Attach, but do not secure, sidearm (4) to the chassis using bolts (6). Fit bolts (7) & (8) to the cross bar.
6. Attach, but do not secure, sidearm (5) to the vehicle using bolts (6). Secure sidearm (4) to sidearm (5) using bolts (10).
7. Tighten all bolts to the recommended torque values (See table above).

Note: This towbar must be used with a Class A50-1 or A50-X towball, which dimensionally conforms to A50-1 with a 'D' & 'S' value greater than or equal to that of the towbar.

****Manufacturers towing limits must be observed for towing capacity****