

Alfa Romeo MiTo 2008-

Partnr.: AF-010-DHU

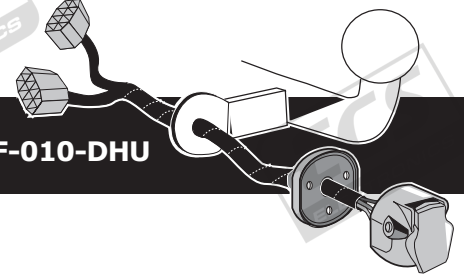

- Fitting instructions electric wiring kit tow bar with 13-P socket up to DIN/ISO Norm 11446.
- We would expressly point out that assembly not carried out properly by a competent installer will result in cancellation of any right to damage compensation, in particular those arising by virtue of the product liability act.
- Contents of these kits and their fitting manuals are subject to alteration without notice, please ensure that these instructions are read and fully understood before commencing installation.
- Do not overload circuits; the maximum loads per connection are detailed in this manual.
- Attention! Before Installation, please read this manual carefully and inform your customer to consult the vehicle owners manual to check for any vehicle modifications required before towing.
- In the event of functional problems, troubleshooting must be limited to about 0.5 hours, contact the technical support:
t.skinner@ecs-electronics.com / 07440 202 052.



Part list

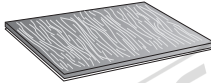
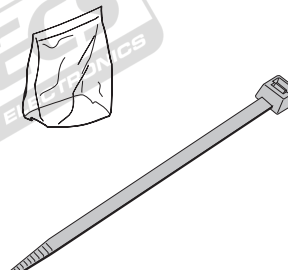
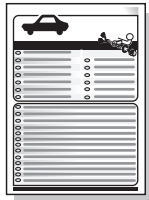
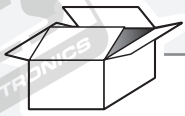

B

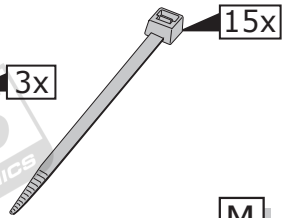

M

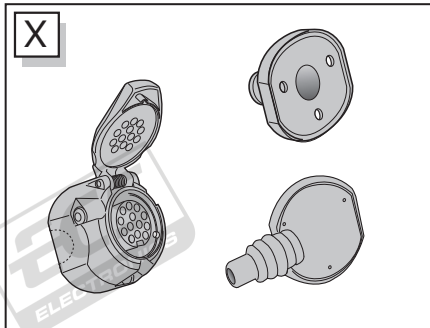
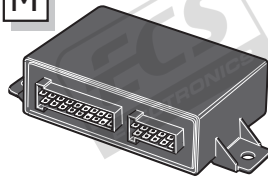

R1

L1

M

B

L2

G

X

U1

3x

U3

U2

U1

Option! *

PARK DISTANCE CONTROL

↓

PARK DISTANCE CONTROL

Pag. 11

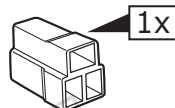
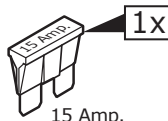
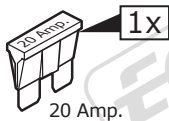
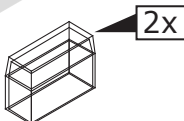
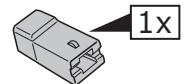
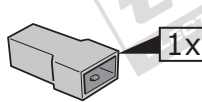
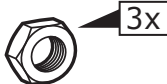
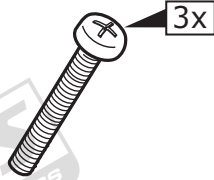

ROUTING

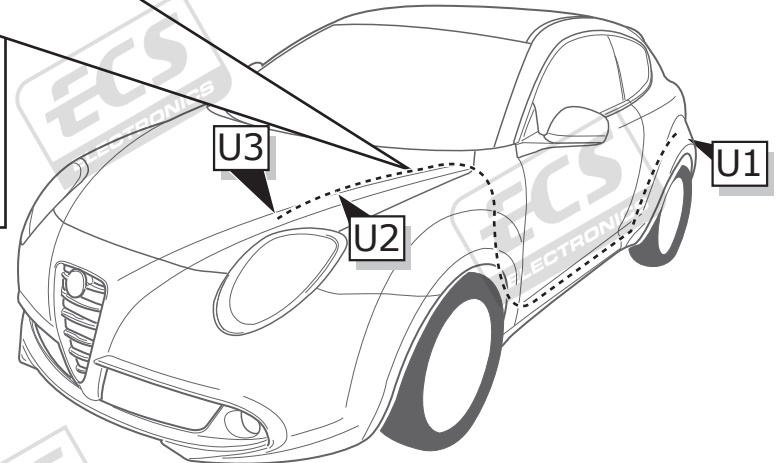
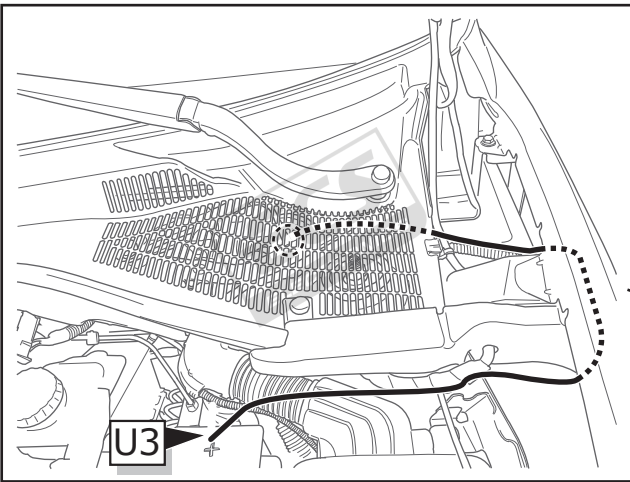
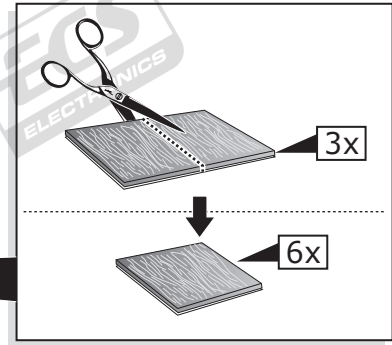
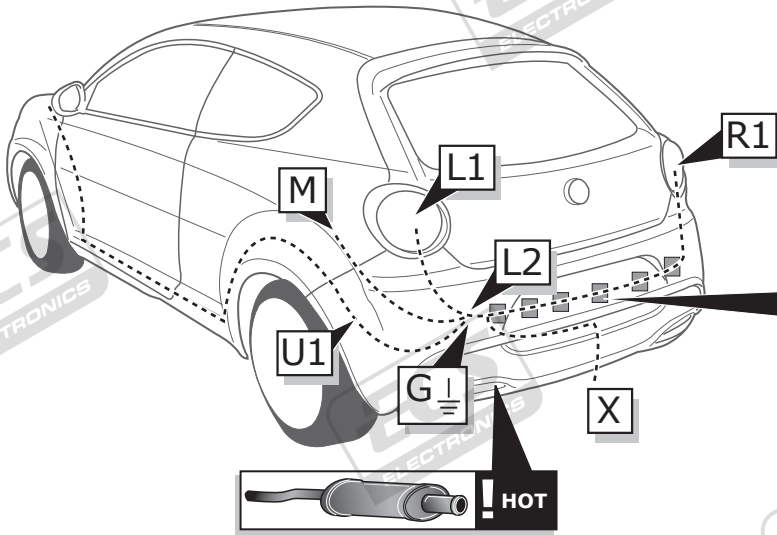

1

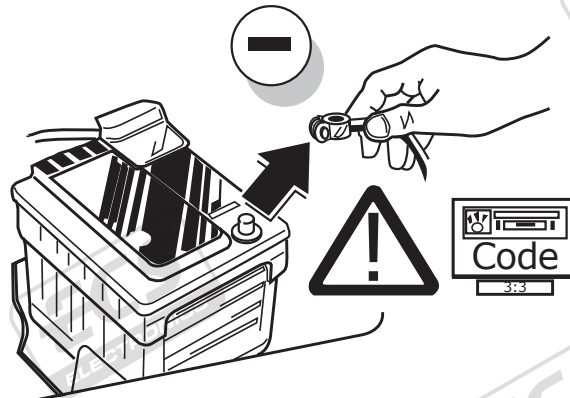

2

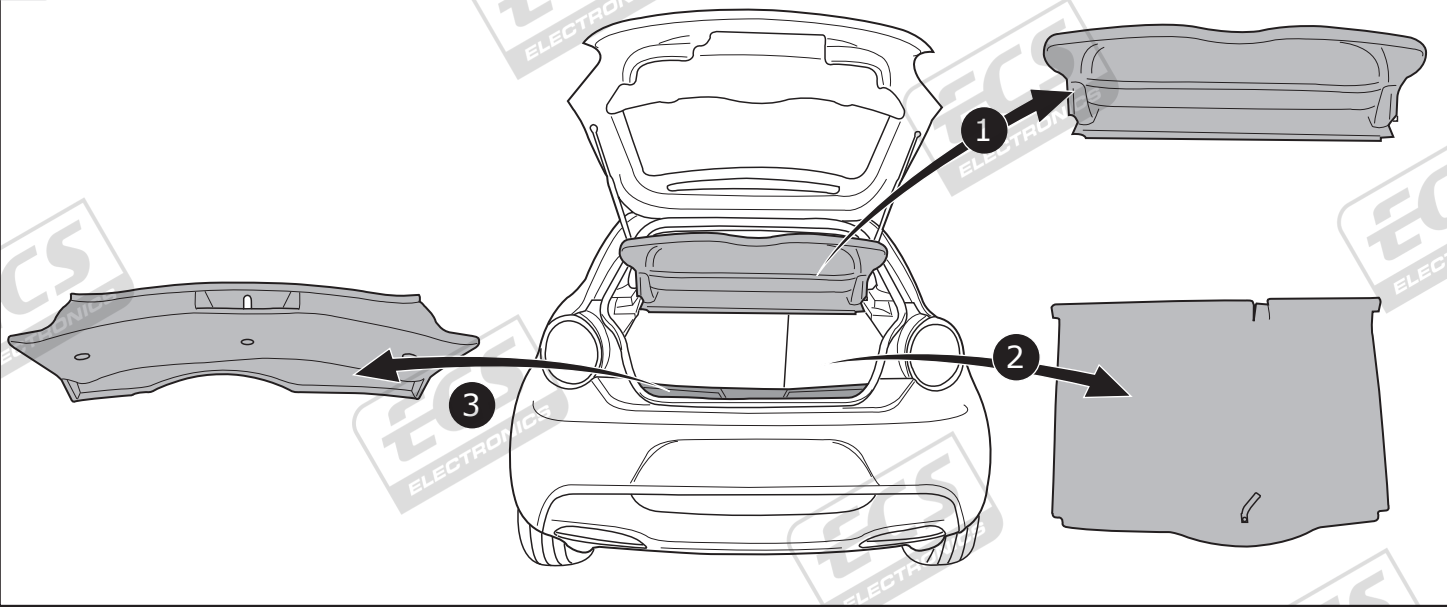

3

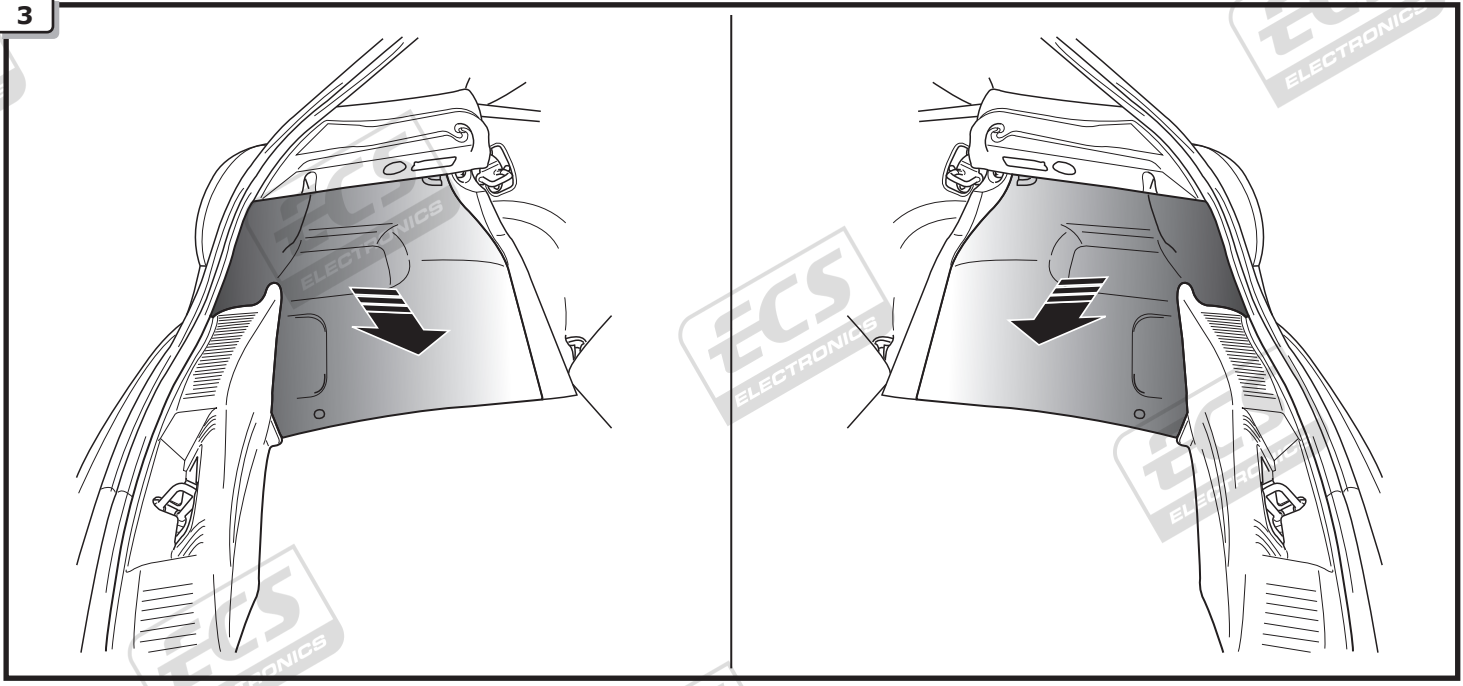

4

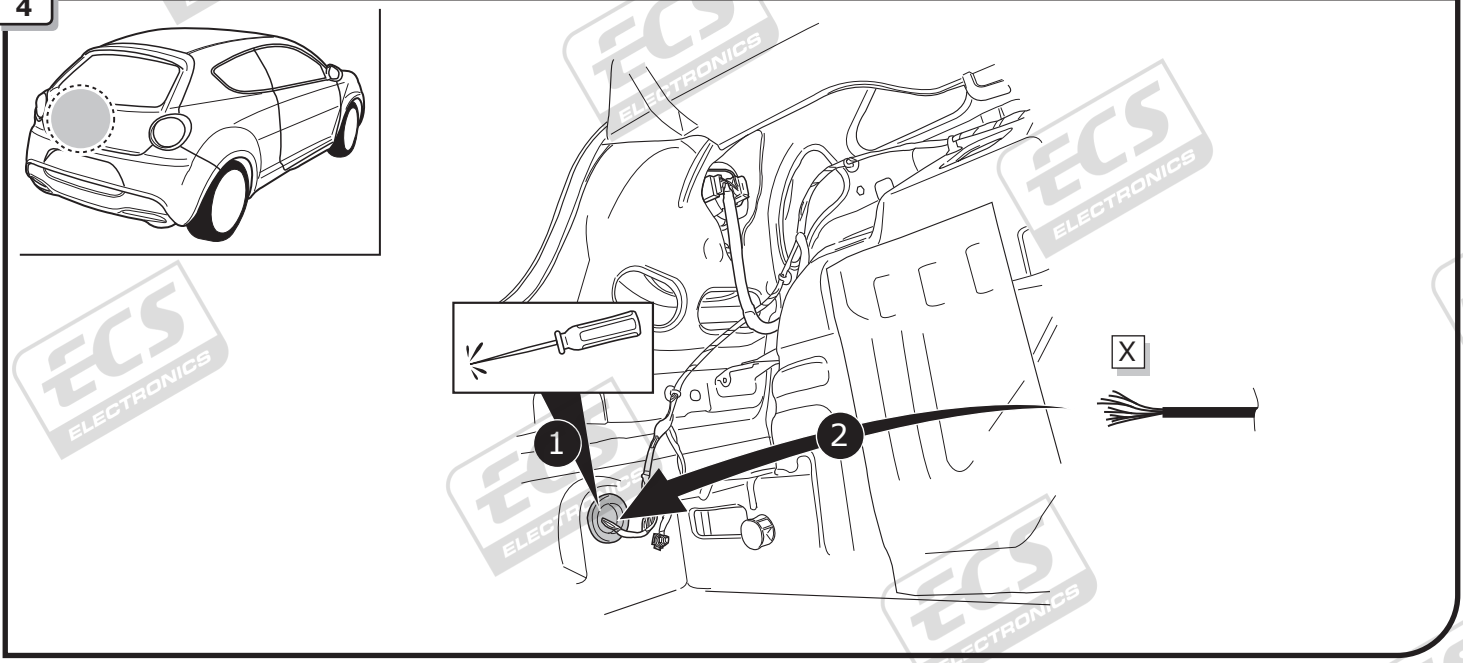

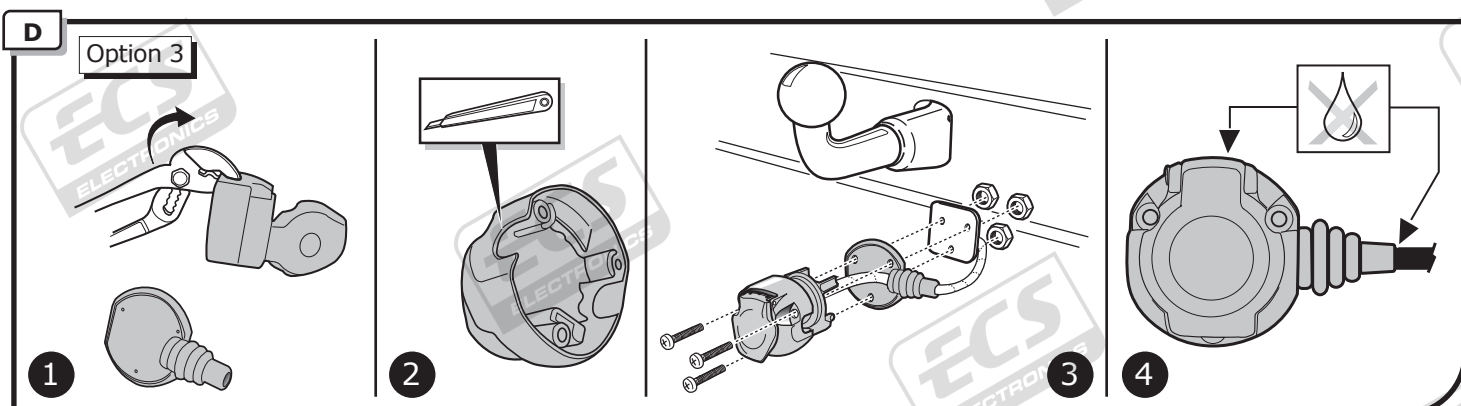
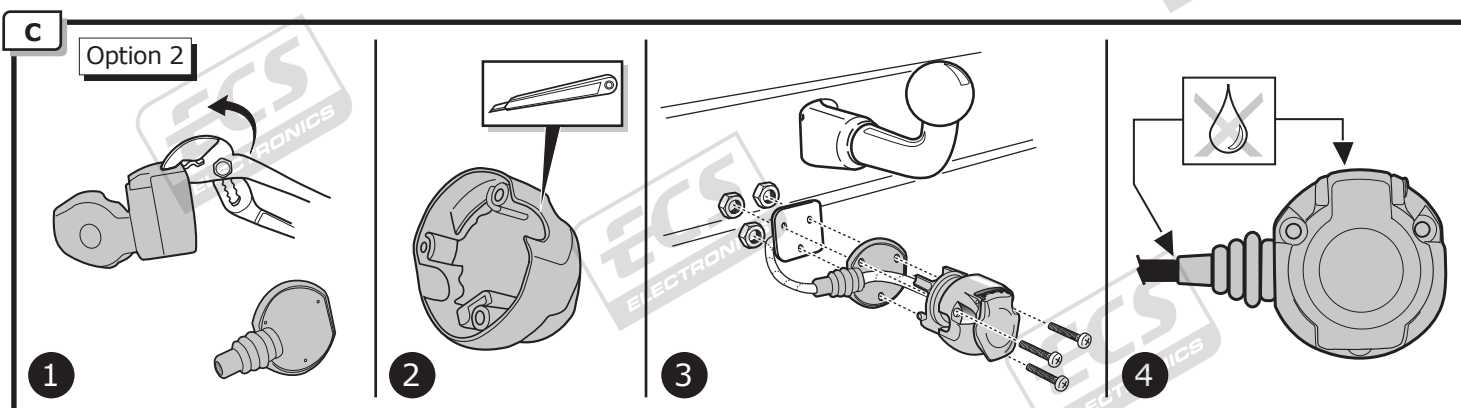
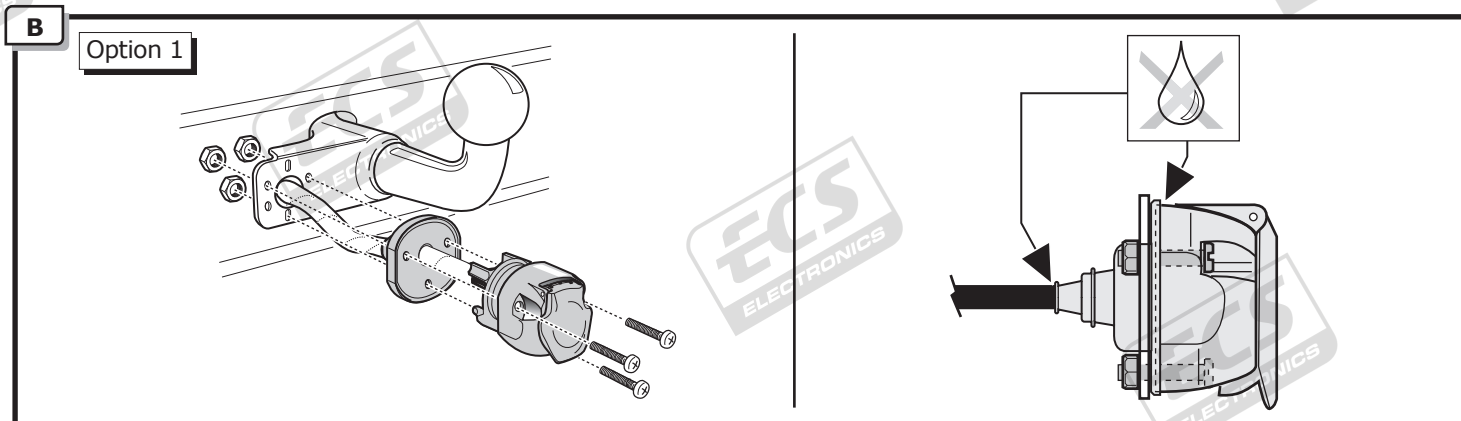
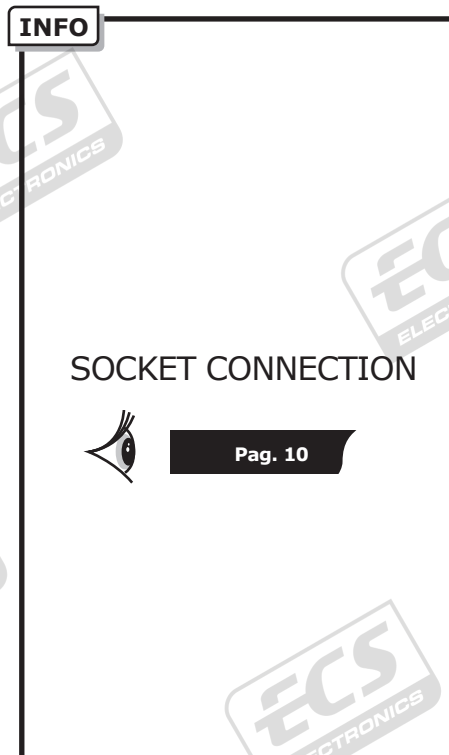
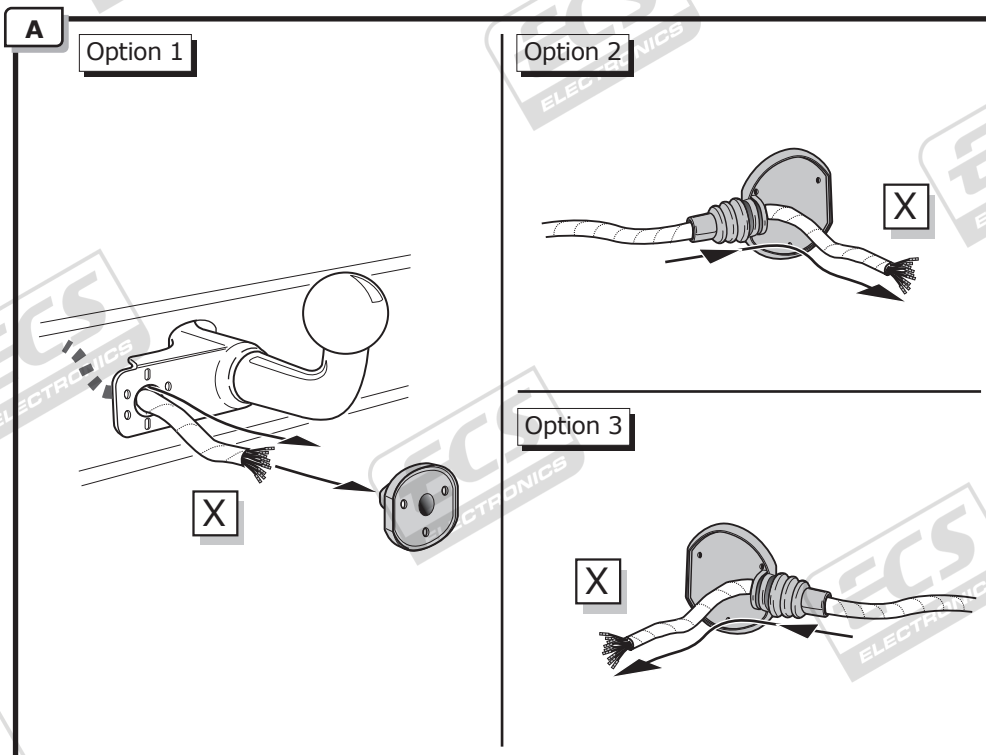

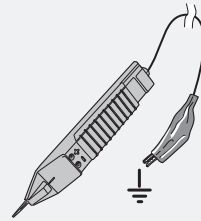
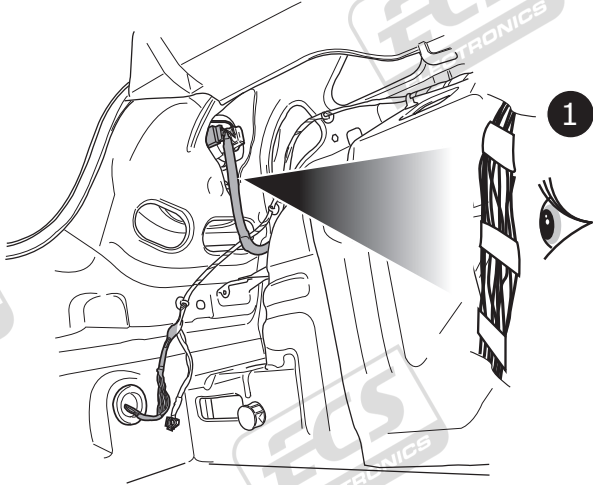
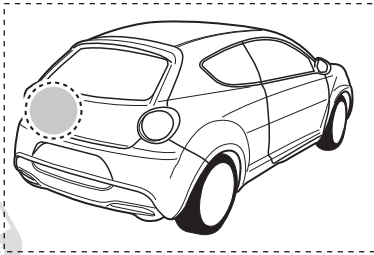

Colours

1	54 STOP	Green/White	Green/White	
1	58L	Yellow/Red	Yellow/Red	
1	L ←	Blue/White	Blue/White	
2	58R	Yellow/Black	Yellow/Black	
2	R →	Blue/Black	Blue/Black	
3	Reverse	Grey/Green	Grey/Green	
3		Brown/Yellow	Brown/Yellow	

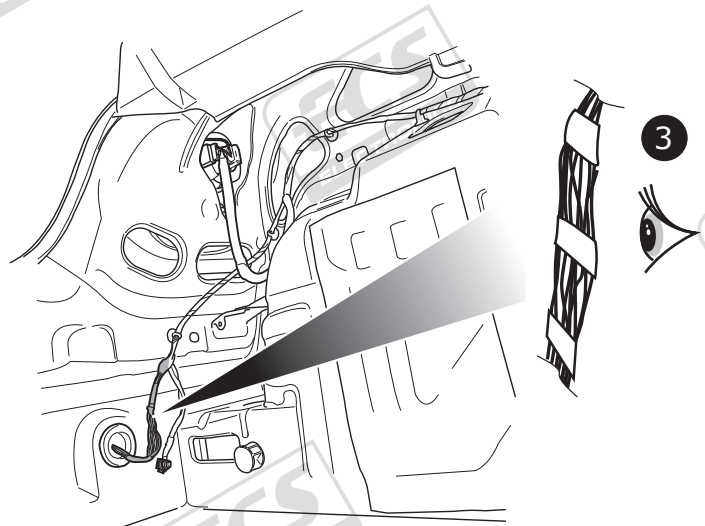
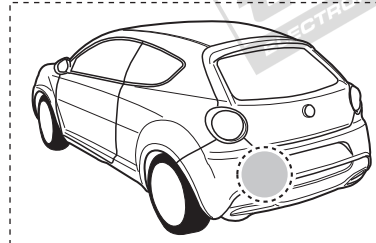
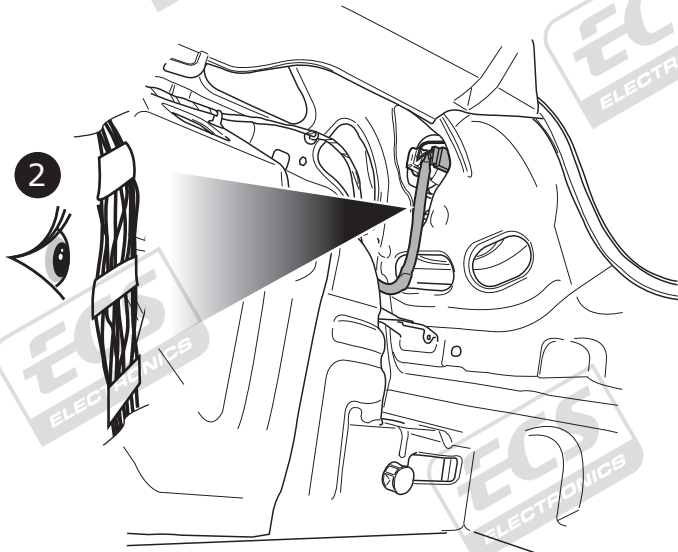
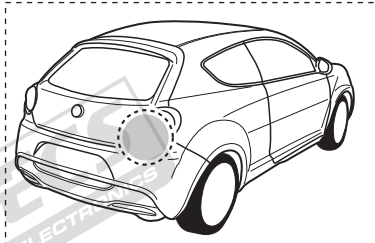

6

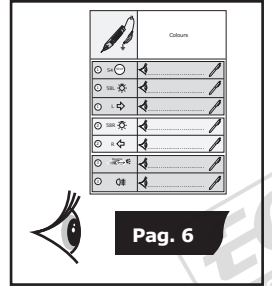
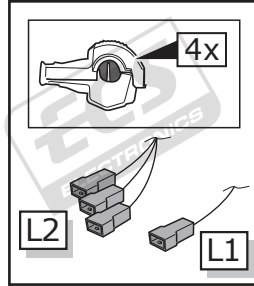
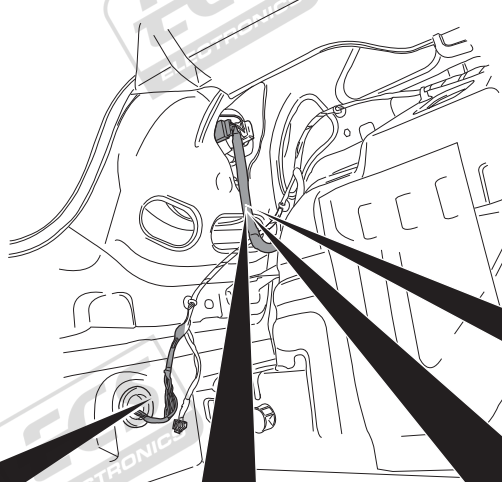
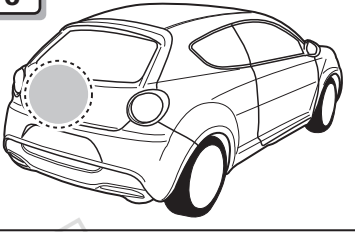

1 Reverse

2 Reverse

3 L1 Green/Red Reverse

1 L ←

2 L ←

3 L2 Black/Yellow L ←

1 58L

2 58L

3 L2 Purple/Black 58L

1 54 STOP

2 54 STOP

3 L2 Blue/Red 54 STOP

7

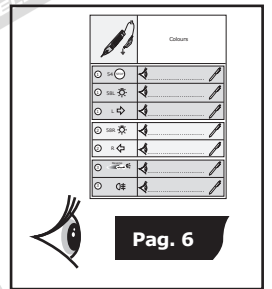
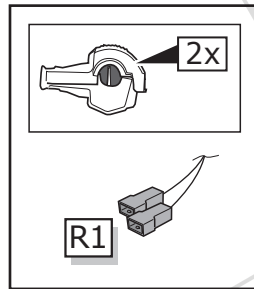
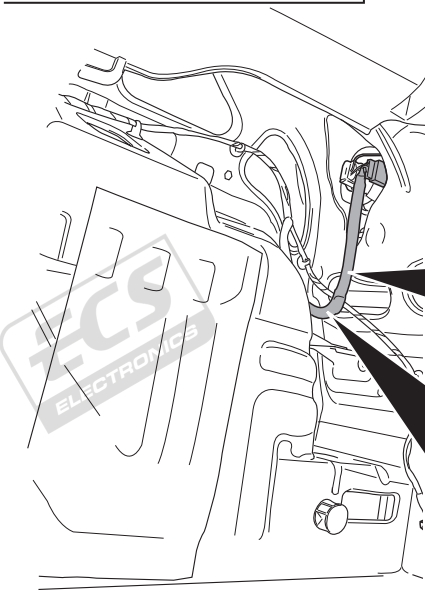
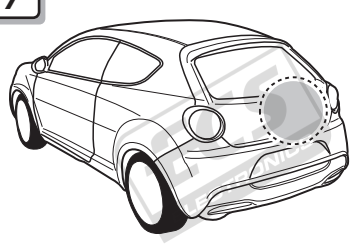

1 R →

2 R →

3 R1 Black/Green R →

1 58R

2 58R

3 R1 Black/Brown 58R

1 R →

2 R →

3 R1 Black/Brown 58R

8

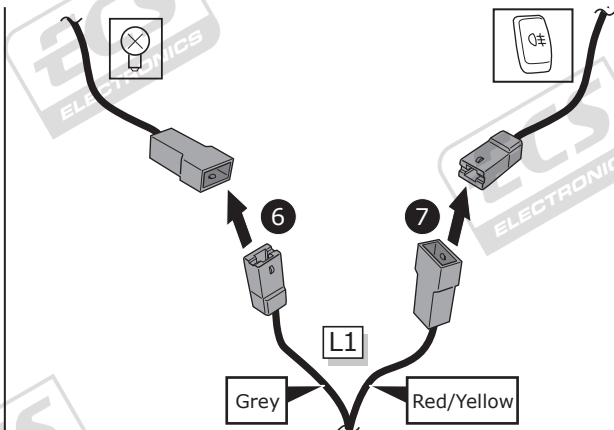
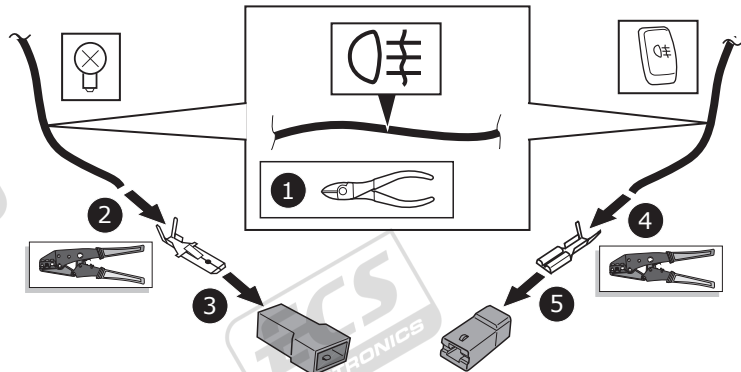
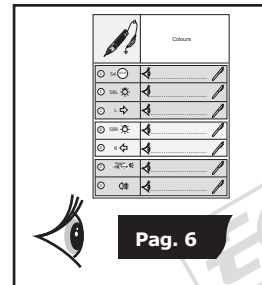
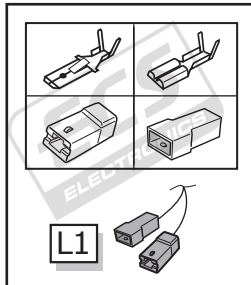
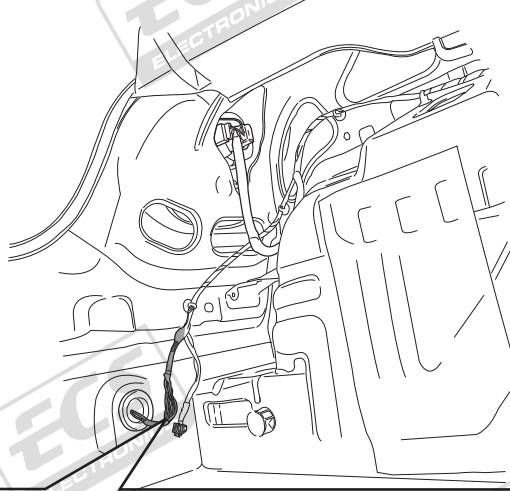
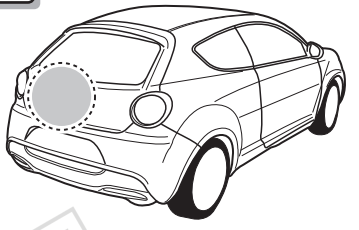

9

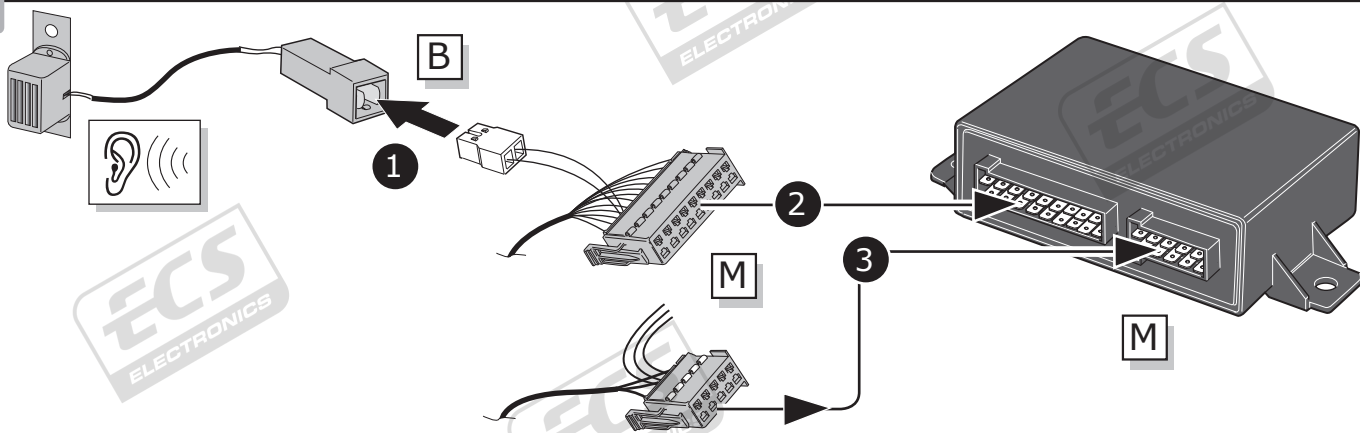

10

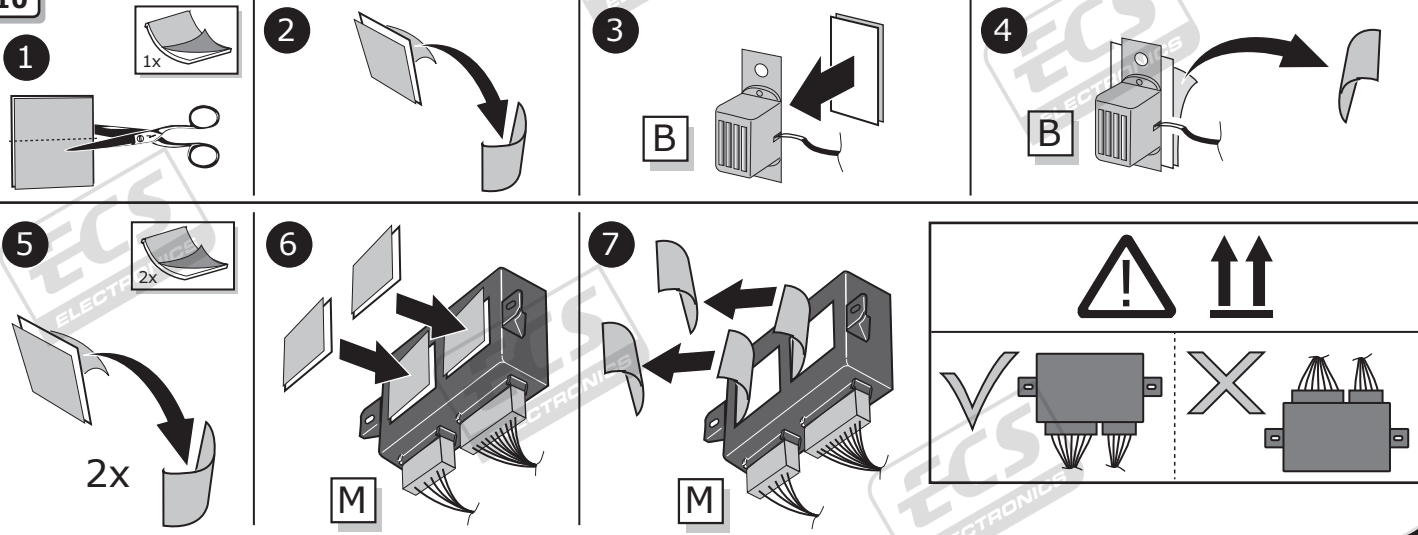

11

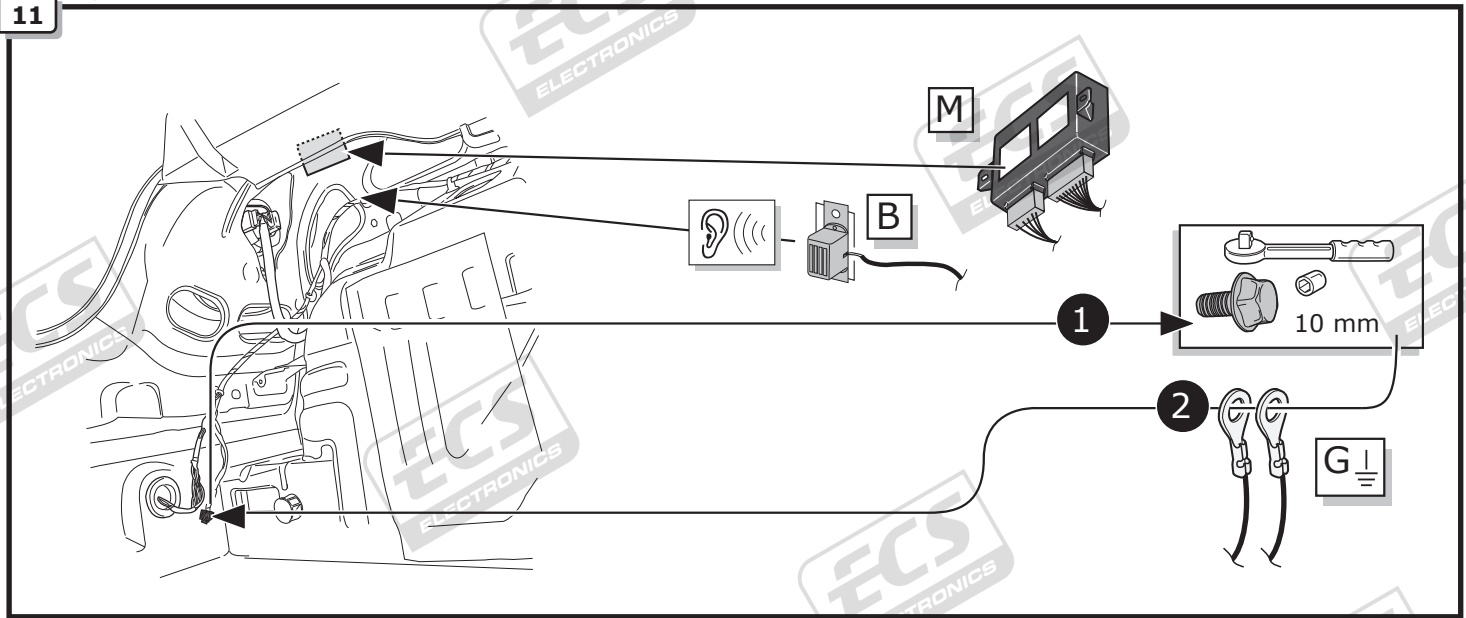

12

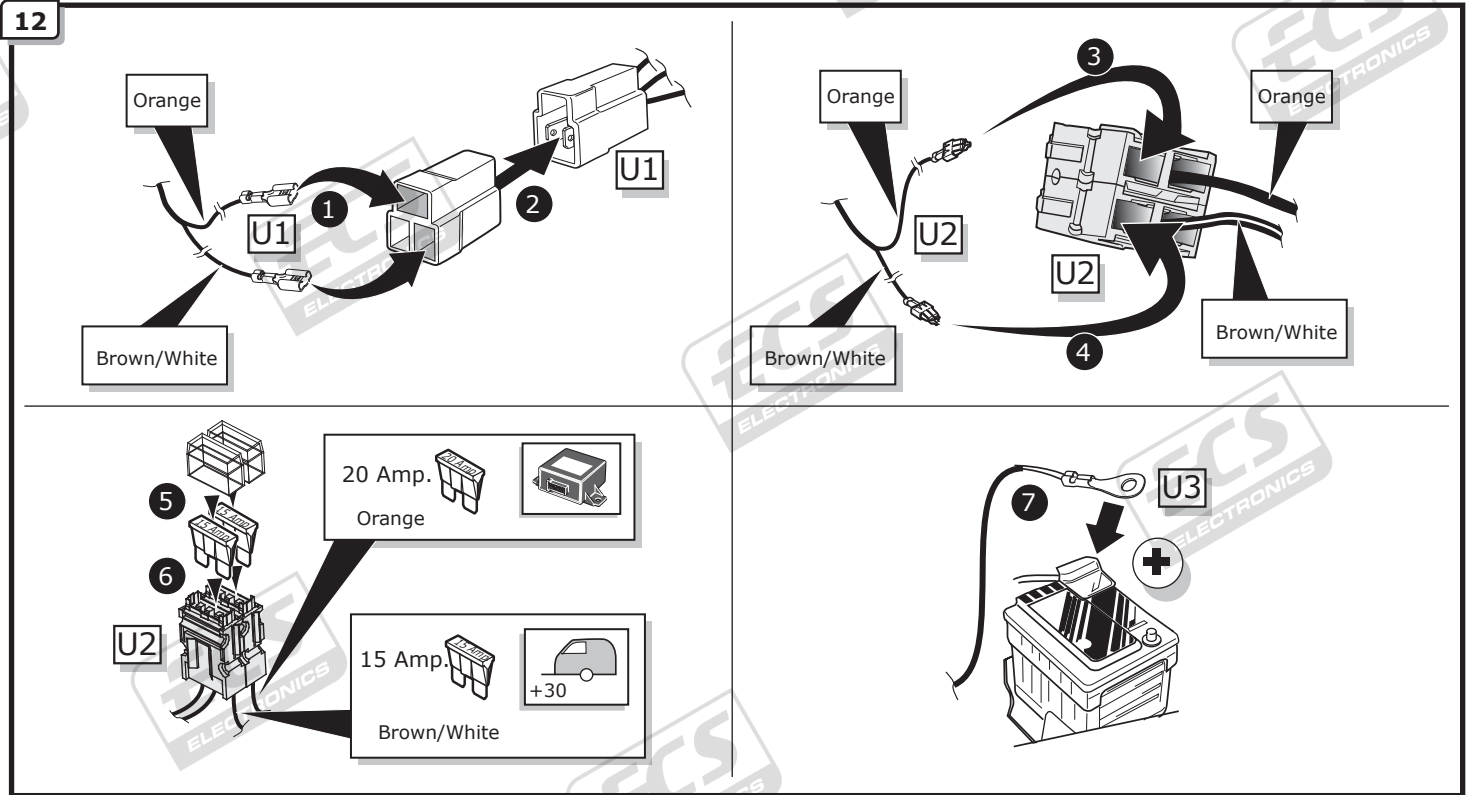

13

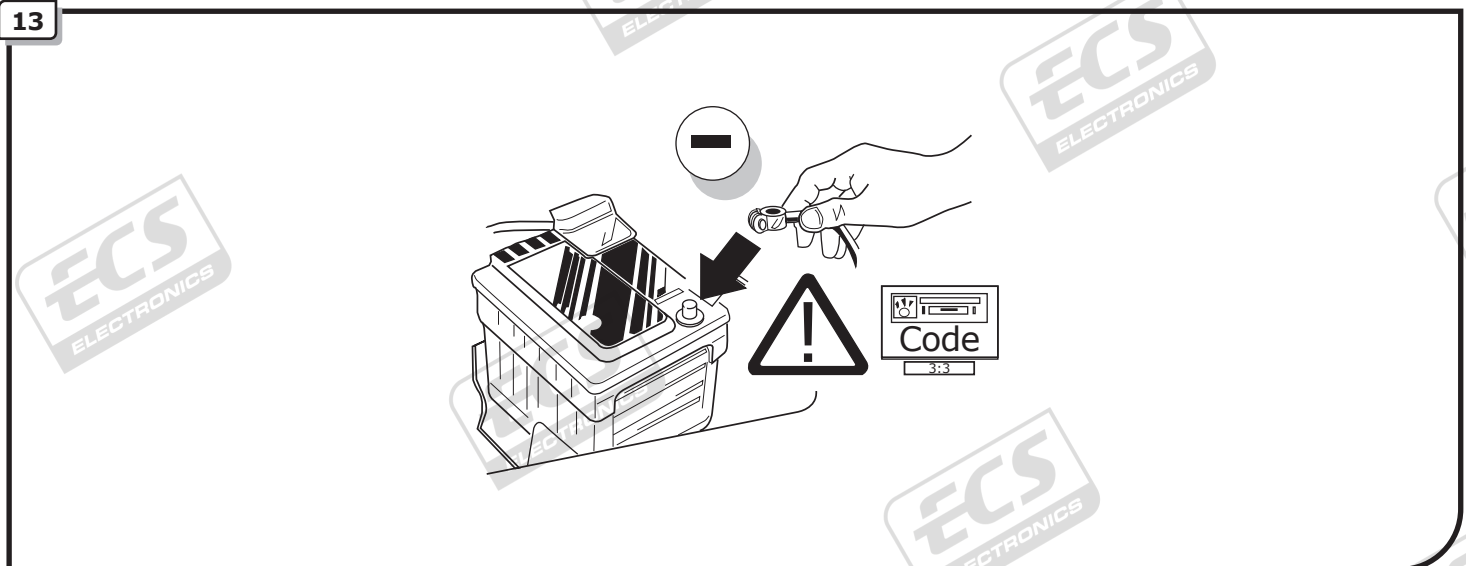

! TEST ALL THE CIRCUITS WITH A TEST DEVICE WITH THE CORRECT POWER LOAD FOR EACH FUNCTION. A TEST DEVICE WITH LED'S CANNOT BE USED FOR THIS PURPOSE.

INFO

REINSTALL TRIM.

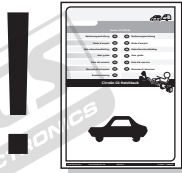
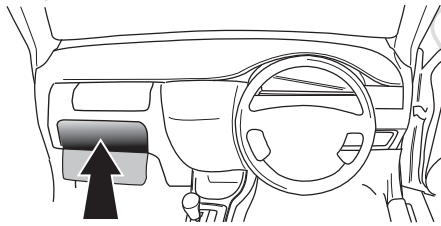

User guide



INFO

SOCKET CONNECTION

DIN/ISO 11446													
	1/L	2	3/31	4/R	5/58-R	6/54	7/58-L	8	9	10	11	12	13
Pmax	21W	2x21W		21W	52W	3x21W	52W	2x21W	180W/15Amp	180W/15Amp			
Colour	Yellow	Blue	White	Green	Brown	Red 1,00 mm ²	Black	Black/ Red	Brown/ White	Red 2,50 mm ²	White	-	White

Option



PARK DISTANCE CONTROL



PARK DISTANCE CONTROL

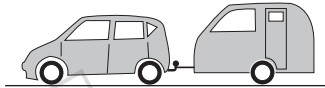

1

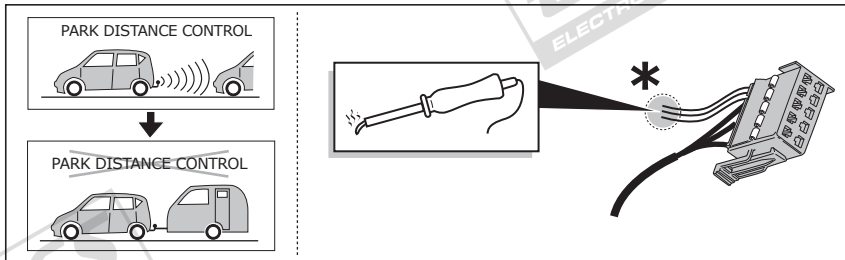

2

Option A

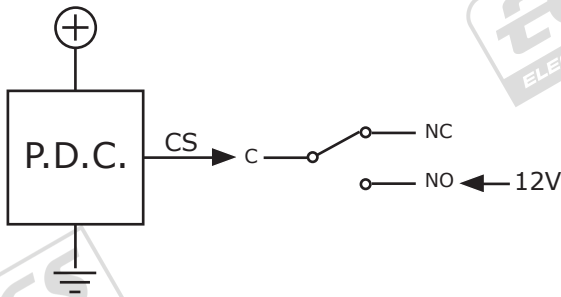

Option B

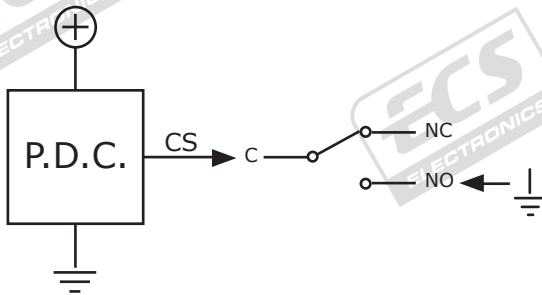

Option C

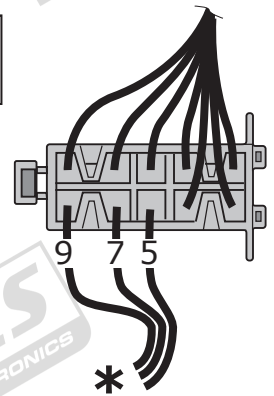
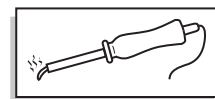
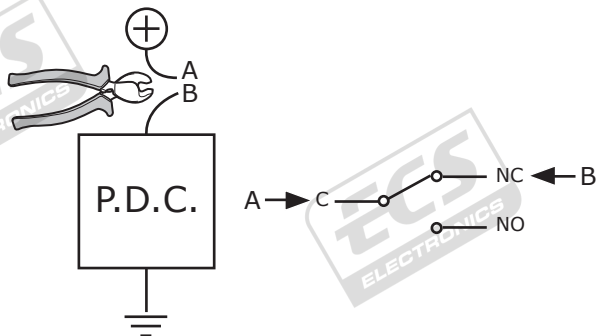

9 = C
Red/Black

7 = NC
Blue/Black

5 = NO
Blue/White